

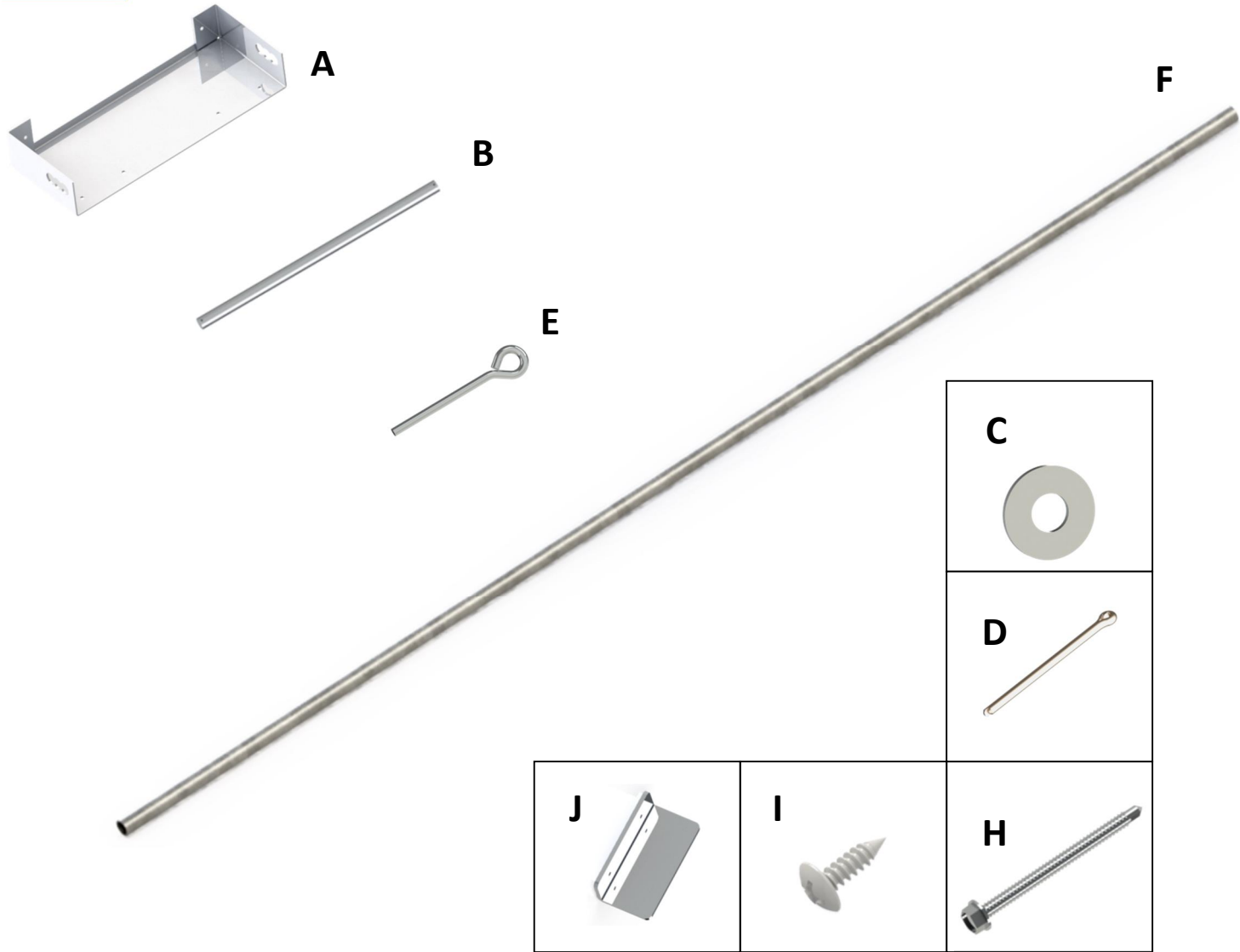

# Installation Instructions for Pop-Up Chute Adapter



Ref	Qty	Description	Notes
A	2	POP-UP CHUTE MOUNTING BRACKET	
B	2	15" ALUMINUM ROD	
C	4	3/4" FLAT WASHER	NOT TO SCALE
D	4	COTTER PIN	NOT TO SCALE
E	2	EYE BOLT	
F	1	GAVANIZED STEEL TUBE	
G	1	REFRIGERATION CHUTE	NOT SHOWN
H	4	SELF TAPPING SCREW	NOT TO SCALE
I	4	SCREW, SHEET METAL	NOT TO SCALE
J	2	L-BRACKET	NOT TO SCALE



# Installation Instructions for Pop-Up Chute Adapter



Scan for Installation Video

Scan for Installation PDF

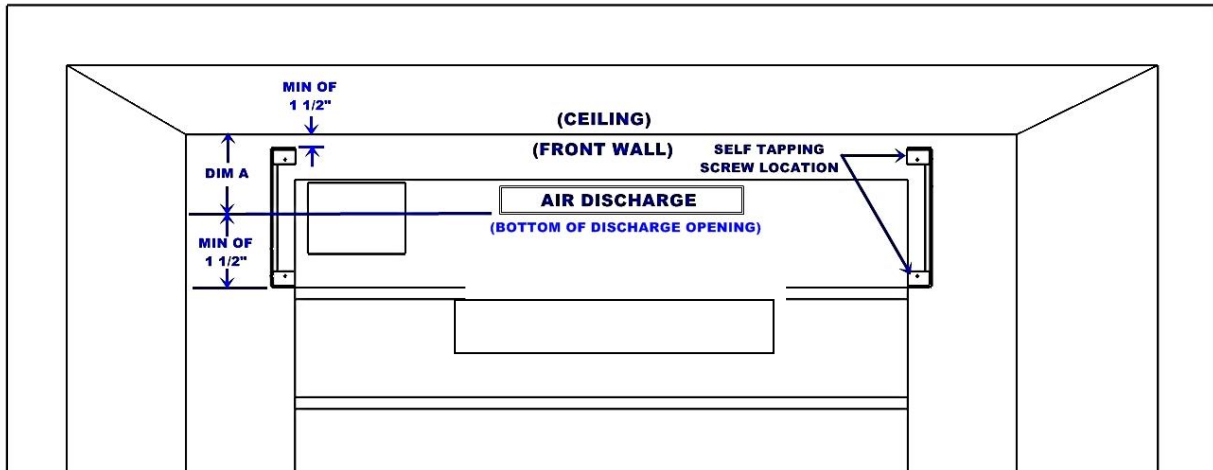

1. Check the parts list (Page 1) to ensure that you have all required components to complete installation.
2. Measure distance from ceiling to the bottom of the **Air Discharge** opening(s). Note this as **DIM A**.
3. Add  $1\frac{1}{2}$ " to **DIM A**. Measure and mark this new dimension next to the refrigeration unit. This will be the minimum distance between the bottom of the mounting bracket and the bottom of the **Air Discharge**.

**Note:** Try to first position the bracket  $1\frac{1}{2}$ " from the ceiling and then ensure that you have at least  $1\frac{1}{2}$ " below the **Air Discharge** opening. If you do not have the minimum  $1\frac{1}{2}$ " below the **Air Discharge** opening, lower as required so as to maintain the minimum clearances of  $1\frac{1}{2}$ ".

4. Position the bracket against the front wall as shown above. Slide inward against the refrigeration unit. Position  $1\frac{1}{2}$ " from the ceiling (See Note above) and secure with two self-tapping screws. Do this for right and left sides.

## Installation Instructions for Pop-Up Chute Adapter

5. Fully assemble one of the brackets as shown. Note: Do not assemble both brackets.

- 1) Install Cotter Pin in aluminum bar
- 2) Slide Washer over bar
- 3) Begin to insert bar in bracket as shown
- 4) Install eyebolt over bar as the bar is slid into position
- 5) Insert bar through upper washer
- 6) Secure with cotter pin.
- 7) Position L-shaped bracket to the inside of the main mounting base
- 8) Secure with 2 screws (Do not overtighten)

Custom Assembly Note: On some versions of the mounting base, you may install bar in different positions (further forward or back) so as to create a forward slope as the travels down the aluminum bar. This is for custom installations and may improve the seal between the header bar and the evaporator unit. Contact Customer Service with questions.

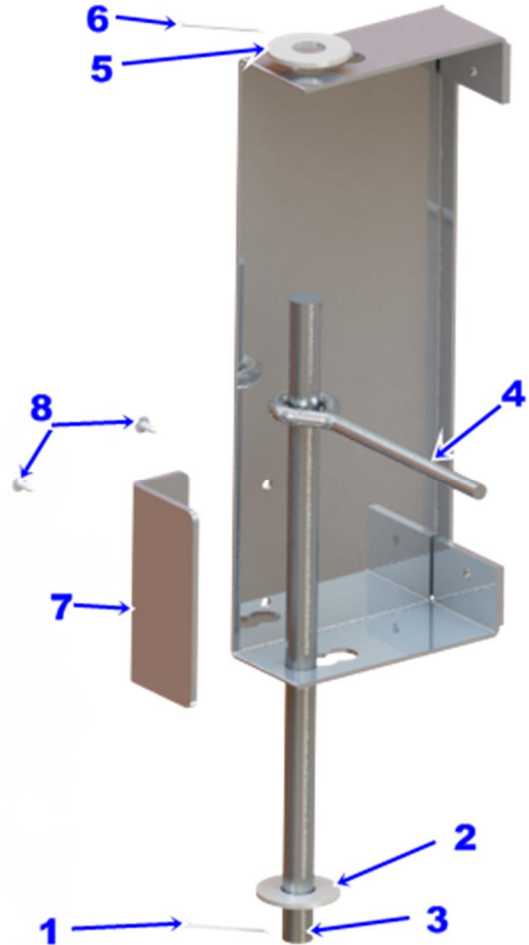

6. Slide the Galvanized Steel Tube through the loop at the bottom of the header flap.  
**Note: Ensure that the inside stitching faces the inside of the header when installed. It is possible to install the header inside out.**
7. Assemble the opposite bracket as shown above with the following exception:  
Prior to (step 4 above) inserting remaining eyebolt on aluminum bar, position the Galvanized Steel Tube on the previously installed eyebolt and then insert the remaining eyebolt into the Galvanized Steel Tube. You may then position the remaining eyebolt onto the aluminum bar and finish the assembly.
8. Secure the Galvanized Steel Tube in a fully down position while completing the header installation.
9. Complete Header and Chute Installation per chute installation instructions.